

## TWIST FEEDER

### ACCESSORIES

As an alternative to the standard stopper supplied for installation on the line pipes, it is possible to use a lowered version for breeding in cages.



| Position | Code                    | Description                                  |
|----------|-------------------------|--|
| 1        | 0307012.00              | Complete hopper set                          |
| 2        | 0307014.00 / 0307015.00 | Pipe auger Ø45 / Pipe auger Ø90              |
| 3        | 0307016.00              | Pipe Ø45                                     |
| 4        | 0307020.00              | Sensor                                       |
| 5        | 0307021.00              | Pipe flange Ø45                              |
| 6        | 0307022.00              | Motorless control unit                       |
| 7        | 0307024.00              | Control unit with motor and gearmotor        |
| 8        | 0307025.00              | Motor for control unit                       |
| 9        | 0307028.00              | Pipe clamp Ø45                               |
| 10       | 0307029.00              | Hopper base                                  |
| 11       | 0308101.00              | Twist feeder plate                           |
| 12       | 0308102.00              | Twist feeder cone                            |
| 13       | 0308103.00 / 0308104.00 | Standard stopper / Twist feeder flat stopper |

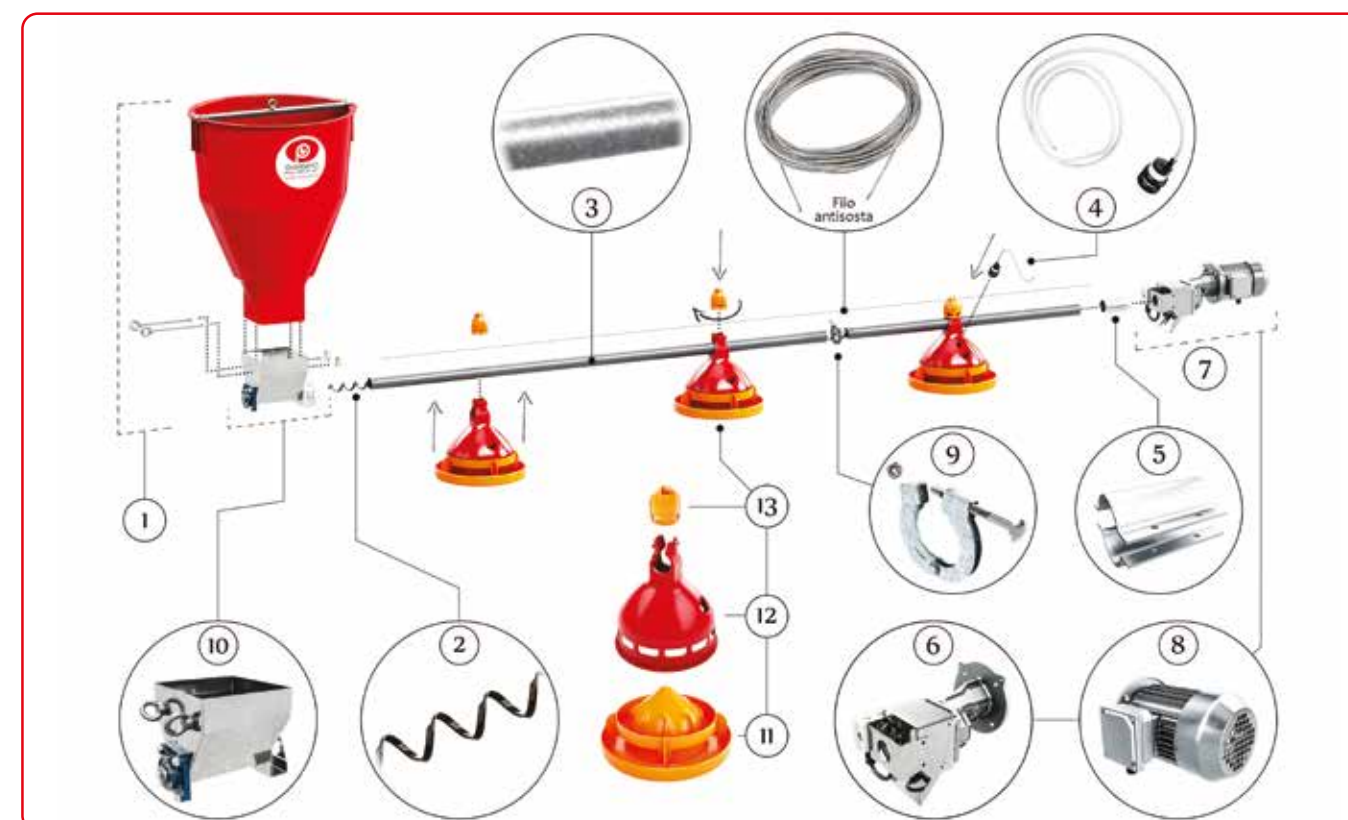

**GIORDANO**  
POULTRY PLAST®

purely professional.

Giordano Poultry Plast S.p.A.  
Via Bernezzo, 47  
12023 CARAGLIO - Cuneo - Italy  
Tel. +39 0171 61.97.15  
Fax +39 0171 81.75.81  
info@poultryplast.com

GIORDANO POULTRY PLAST S.p.A. reserves the right to modify products' features and data contained in this catalogue, and accepts no liability for errors and/or omissions in the published information. All rights reserved, including translation rights. The complete or partial reproduction of this publication without the authorization of Giordano Poultry Plast S.p.A is prohibited.



[www.poultryplast.com](http://www.poultryplast.com)

**GIORDANO**  
POULTRY PLAST®  
[www.poultryplast.com](http://www.poultryplast.com)

## USER'S HANDBOOK



**TWIST**



## THE PRODUCT

**Twist** is a product unique in the world. Designed down to the tiniest details to better meet your needs, it is the first patented feeder with the fewest pieces on the market.

Twist consists of a plate, a bell and a stopper, 3 pieces only that enable an easy and effective washing for the benefit of durability, easy handling and reduced weight.

## IN DETAIL

The **Twist** product is dedicated to the "broiler", breeding.

Through a system of retractable louvers, the feeder allows the quantity of feed released to be varied depending on needs: in this way, you can thoroughly follow each stage of growth of the chick until it has reached adulthood, always ensuring the adequate feed supply.



## DATA

**Production:** Made in Italy

**Material:** 100% virgin polyethylene treated for UV rays

**Diameter of plate (Ø):** 350 mm

**Circumference of plate:** 1100 mm

**Depth of plate:** 40 mm

**Weight:** 0.83 kg

**Customer's name:** N°1 free plug

### Characteristics:

- Anti-waste protection and plate inclined inwards to minimise waste
- No adjustment or manipulation necessary for the washing
- Excellent performance confirmed by several tests on the ground

### Standard packaging:

- 20 bells per box (540x540x570 mm)
- 20 plates per box (710x360x1010 mm)

**Shipping capacity:** 1.200 units per 20ft container

## TWIST FEEDER



## HOW IT WORKS

The production cycle entails 2 distinct stages of animals growth:

- a first stage, characterised by important quantities of feed for the weaning of animals.
- a second stage, of fattening, where quantities are reduced to minimise waste.

## WEANING

In this first stage, it is essential that the feed be always present abundantly inside the plate.

The **Twist** should therefore be placed on the ground, taking care to let the bell drop until it rests on the plate: in this way, the louvers found along the entire perimeter are free and enable the maximum quantity of feed to pass through. The level reaches even below the anti-waste edge, progressively increasing inwards: the chicks accordingly have an easy access and direct visual contact with the feed, which is instead a rare occurrence in most of the other feeders.

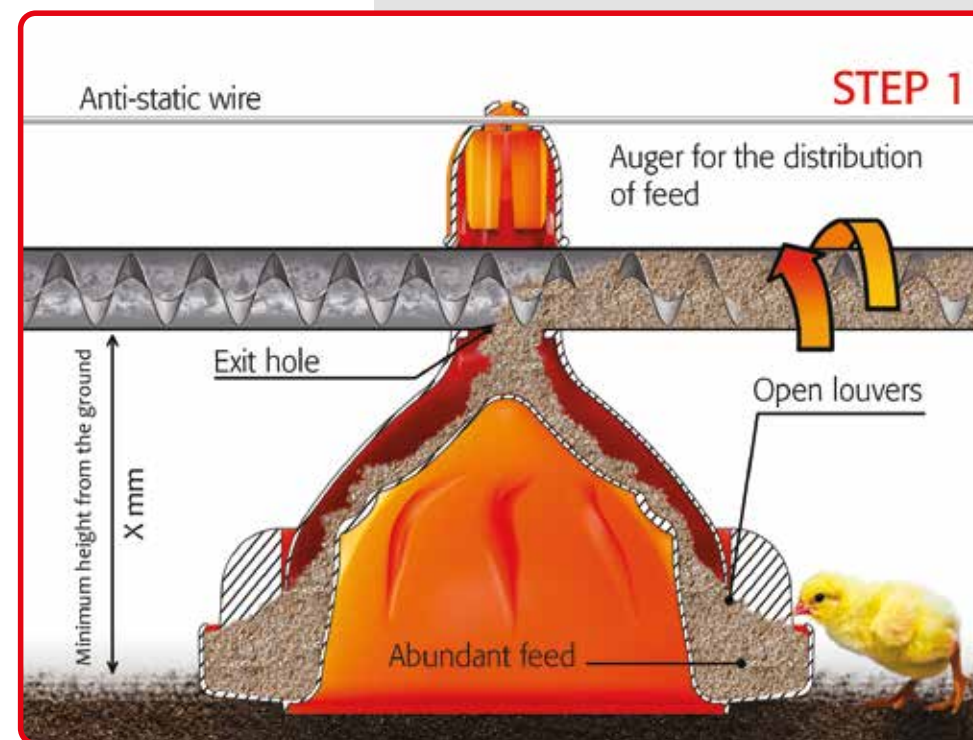

## FATTENING

In this second stage, the quantity of feed supplied to the animal should be reduced in order to ensure minimum waste.

The **Twist** is now raised from the ground and brought to a height suited to the by now adult animals: here louvers are closed, due to the plate sliding on the bell, and the feed only spurts out from the lower outside opening that is created between the two components.

The quantity of feed is rationed, covering just the surface of the plate, while the help from the anti-waste edge limits its dispersion outside the feeder.

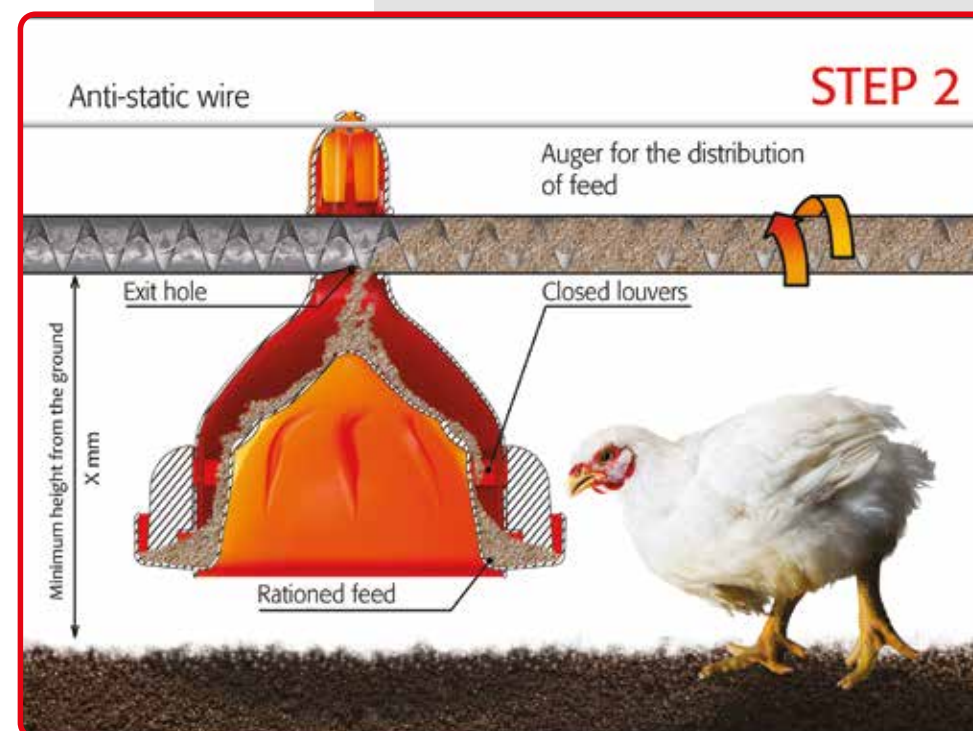

## TWIST FEEDER

## WASHING

At the end of the production cycle, all the lines must be cleaned from leftover feed, manure and from accumulations of dust: this operation, however, might prove rather demanding, besides being costly, also in terms of time, wherever the installed feeders have a scarcely functional design preventing them from being easily washed or delaying the operator.

Twist simplifies that procedure thanks to the innovative "turbine-style" washing system patented and tested on the ground.

The moment the line is lifted from the ground, you can insert the ferrule of the pressure nozzle into the relevant entrance hole, situated on the front of the bell: in this way, the water gush is correctly directed to the outline of the plate (1), transmitting to it a rotation that distributes it forcefully and speedily in every point of the feeder, thereby ensuring a deep clean both inside and outside.

The inclination (2) of the same one side of the line should not alarm, as it is a temporary circumstance due exclusively to the pressure spurt: once the operation ends, the **Twist** returns to its place on the vertical of the line.

Thereupon, all that is left is to move onto the washing of the next segment: Meanwhile, the water left on the previous plate gradually pours out of the small drain holes.



## TWIST FEEDER